

## Accumulator Head Extrusion Blow Molding Machine

For Production of Containers and Technical Products

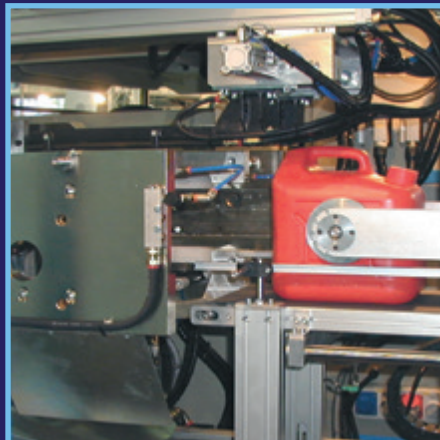
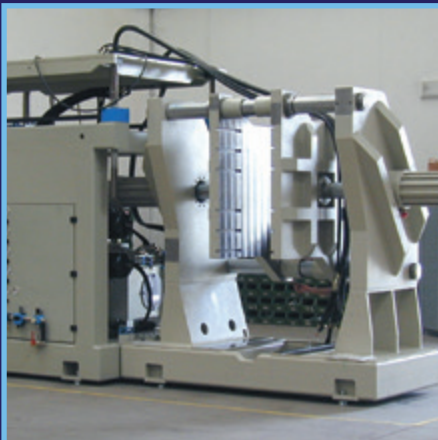

## General Specifications

	US	Metric
Clamp Force	39 US tons	350 kN
Air Pressure	116 psi	8 bar
Air Consumption (Estimated)	117 cfm	3300 lt/min
Hydraulic Cooling Capacity	79,366 btu/hr	20,000 kcal/hr
Mold Cooling Capacity	142,860 btu/h	36,000 kcal/hr
Water Cooling Pressure (Min)	58 psi	4 bar
Total Power Installed (Estimated)	177 kW	177 kW
Dimensions	139.4 x 259.8 x 189 inches	3540 x 6600x 4800 mm
Total Weight	55,116 lbs	25,000 kg

### Extruders (90/24D)

Screw Diameter	3.5 inches	90 mm
Extruder Motor Power	87 hp	65 kW
Max Throughput = PE	441 lbs/hr	200 kg/hr
Heating Power	18.5 kW	18.5 kW

### Clamping

Maximum Daylight (A)	47.2 inches	1200 mm
Minimum Daylight (B)	15.7 inches	400 mm
Clearance Between Tie bars (C x D)	24 x 36 inches	610 x 910
Maximum Closing Speed	23.6 inches/sec	600 mm/sec
Open Stroke (E x 2)	15.7 inches x 2	400 mm x 2

### Accumulator Head

Head Sizes (3)	7.7, 13.2, or 17.6 lbs	3.5, 6, or 8 kg
Maximum Accumulator Value	1.2, 2.2, or 2.9 gals	4.6, 8.22 or 10.8 mm
Minimum Die Diameter	1.2, 1.2, or 1.2 inches	30, 30, or 30 mm
Maximum Accumulator Value	8.7, 11.8, or 11.8 inches	220, 300, or 300 mm
Heating Power	15.2, 18.5, or 29.5 kW	15.2, 18.5, or 22 kW
Number of Heating Zones	6, 6, or 8	6, 6, or 8

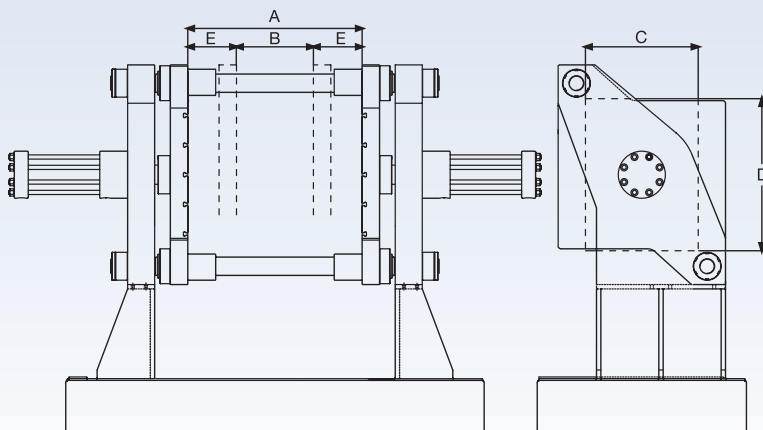

**Jomar**<sup>®</sup>

Exclusive North American Distributor  
of Automa EBM Machines

**automa** by **magic**

115 East Parkway Drive  
Egg Harbor Township, NJ 08234 USA  
1-609-646-8000  
jomarcorp.com  
sales@jomarcorp.com